



# RJ701 Pull (Multi-Use)

Cabinet Door / Drawer / Full Size Door / Appliance

#RAJACK

# TYPE

# G

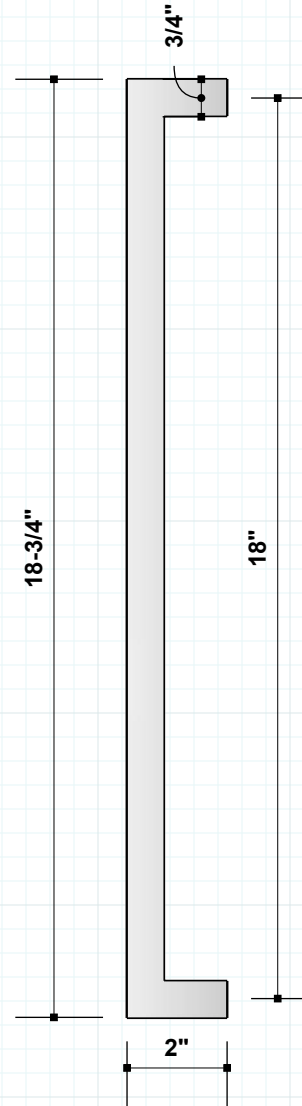
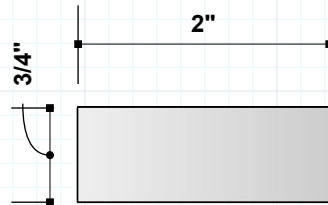
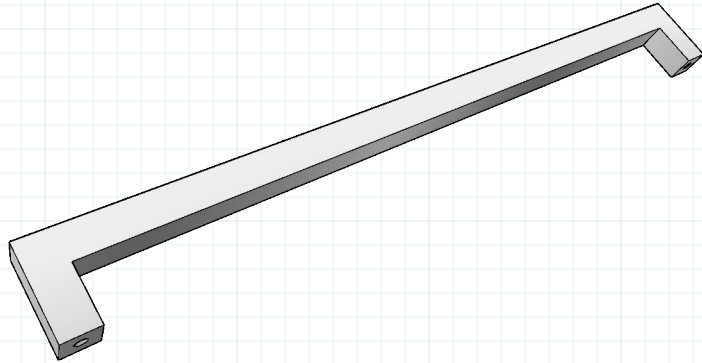

**3/4"**

MATERIAL THICKNESS (THK)

**3/4"**

MATERIAL WIDTH (W)

**2-00"**

MATERIAL PROJECTION (P)

**4-00" up to 24"**

MATERIAL OA LENGTH (L)

## SAMPLE CUT SHEET

RJ701 Pull - TYPE G - 18-3/4" OA (18" CTC)

RJ701-G-1

 **RAJACK.com**

 **rajackhardware**  
*Follow us on Instagram*

**info@rajack.com**

**RAJACK HARDWARE**

95 Rome Street  
Farmingdale, NY 11735  
631-293-8273 Phone



# RJ701 Pull (Multi-Use)

Cabinet Door / Drawer / Full Size Door / Appliance

#RAJACK

# TYPE

# G

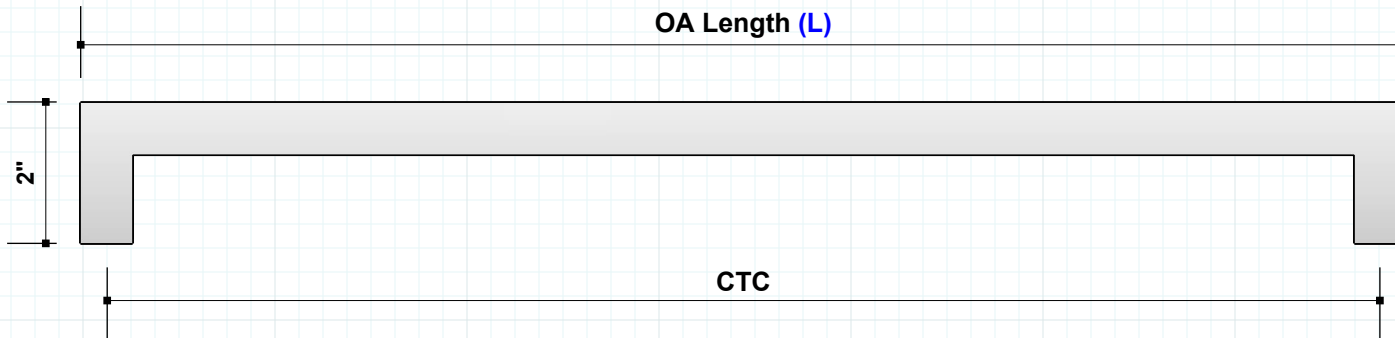

**3/4"**  
MATERIAL THICKNESS (THK)

**3/4"**  
MATERIAL WIDTH (W)

**2-00"**  
MATERIAL PROJECTION (P)

**4-00" up to 24"**  
MATERIAL OA LENGTH (L)

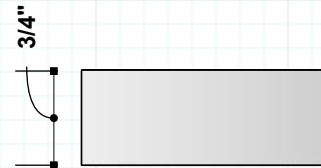

 **rajackhardware**  
*Follow us on Instagram*

**info@rajack.com**

**RAJACK HARDWARE**  
95 Rome Street  
Farmingdale, NY 11735  
631-293-8273 Phone

## MANUFACTURED TO ORDER

Any of the parameters of this pull can be changed to suit your needs. We have made some design suggestions that fall within our normal production cycle for this part and type. Call / Email to discuss sizing.

RJ701-G-2

 **RAJACK.com**